

7000 CROSSING / SIGN / PEACHTREE

STANDARD SIGN CRITERIA  
Peachtree Crossing Shopping Center - Phase 3

Facade Sign:

A facade sign is to be designed, built, approved and installed in strict accordance with the following criteria:

1. Approval. A dimensional colored plan and specifications of tenant's sign shall be submitted to and approved by landlord prior to tenant's applying for a sign permit and prior to tenant's installation of such sign.
2. Applicable Law. Tenants shall cause the manufacturing and installation of its signs to comply with all applicable laws, codes and ordinances including the sign ordinance of Peachtree City.
3. Placement of Signs. Tenant's sign shall be mounted on the fascia above the canopy as show on the project elevation drawings.
4. Sign Dimensions. Each facade sign will be mounted on a bronze background panel 30" tall with a maximum width of 4' 0" less than the shop width. The margin will be: Top-4"; Bottom-6"; Sides-9". Refer to attached drawing.
5. Copy. All facade signs will have individual letters. The letters will be 20" upper and lower case with the first letter of each word to be a captial (upper case) letter and all others to be small (lower case) letters as shown on the drawing. The type of letter style will be one of the following:

Helvetica Medium	Goudy Bold
Optima Semi Bold	Souvenir Demi

Alternative type styles may be approved. Horizontal reduction up to 50% is permitted where necessary.

6. Construction. Facade sign will consist of a fabricated (welded) .080 aluminum sign panel 30" tall by appropriate length with 3" return and 7" radius corners. The letters shall be fabricated from 1/8" acrylic sheets using one of the approved colors. Letters shall have a 2" black plastic return ("Jewelite"). All mechanical fasteners of letters to panel to be aluminum or zinc chrome plated.
7. Colors. A. Face color of letters:

Red	Plexiglas #2662
Orange	Plexiglas #2564
Bright Orange	Plexiglas #2119
Yellow	Plexiglas #2325
Bright Yellow	Plexiglas #2465
Blue	Plexiglas #2329
Ivory	Plexiglas #2146
White	Plexiglas #W-7420

B. Sign panel color--Wyandotte Paint Products Co. super grip flex paint #633, dark bronze.
8. Logos and Trademarks. No logos or trademarks will be allowed on any signs.
9. Installation. Facade sign--aluminum clips will be fastened to the block wall in the mortar joints with lead anchors and zinc chrome plated lag bolts. The panel will be fastened to the clips with zinc chrome plated screws on the returns. No exposed fasteners can be attached to face of sign. Tenant shall be responsible for any damage caused by the installation of the sign.

\_\_\_\_\_  
Landlord's Initials

\_\_\_\_\_  
Tenant's Initials

# PEACHTREE PARKWAY

STATE ROUTE 54 - 80 PW

PEACHTREE CROSSING  
SHOPPING CENTER

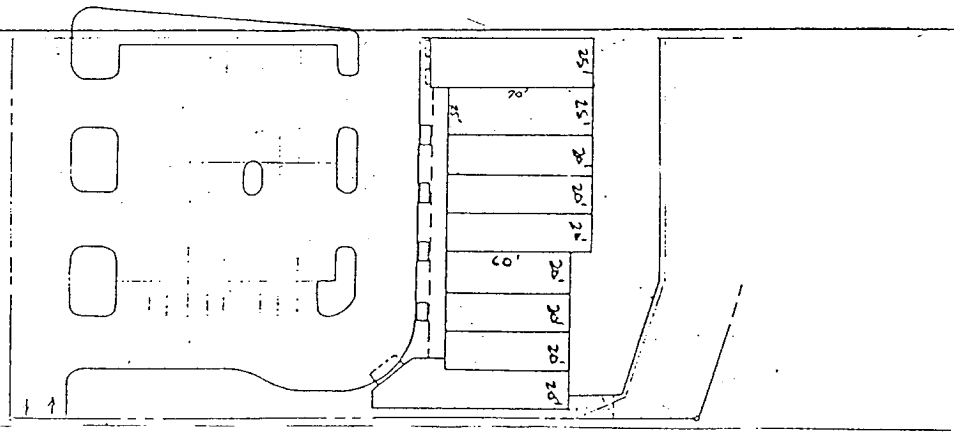
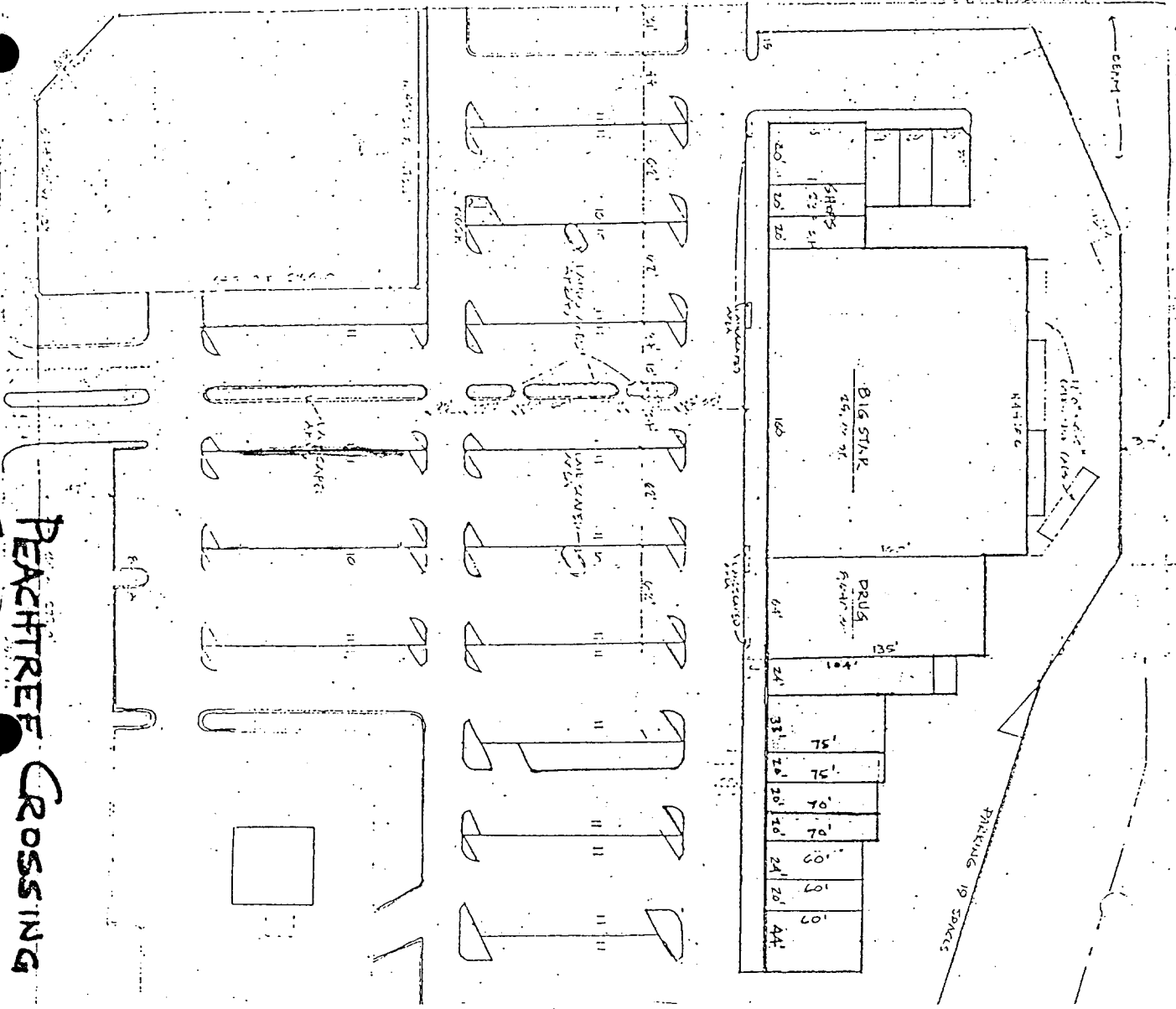

Phase 3